

# Technical data sheet



## Product features

### Pasta cooker 7 l with drain tap

<b>Model</b>	<b>SAP Code</b>	00015019
--------------	-----------------	----------



- Basin volume [l]: 8
- Material: AISI 430
- Protection of controls: IPX4
- Maximum device temperature [°C]: 110
- Basket size [mm]: 1x 210 x 235 or 3x 138 x 100

<b>SAP Code</b>	00015019	<b>Power electric [kW]</b>	3.400
<b>Net Width [mm]</b>	270	<b>Loading</b>	230 V / 1N - 50 Hz
<b>Net Depth [mm]</b>	420	<b>Basin volume [l]</b>	8
<b>Net Height [mm]</b>	370	<b>Basket size [mm]</b>	1x 210 x 235 or 3x 138 x 100
<b>Net Weight [kg]</b>	9.00		

# Technical data sheet



Technical drawing

Pasta cooker 7 l with drain tap

Model

SAP Code

00015019

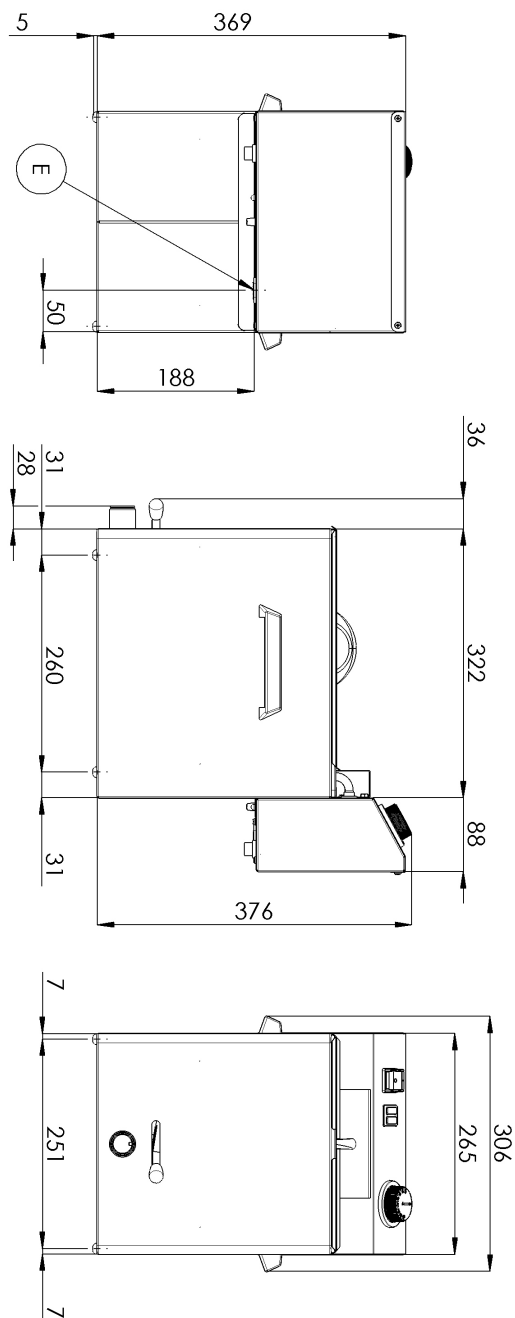

# Technical data sheet



## Technical parameters

### Pasta cooker 7 l with drain tap

Model

SAP Code

00015019

**1. SAP Code:**

00015019

**2. Net Width [mm]:**

270

**3. Net Depth [mm]:**

420

**4. Net Height [mm]:**

370

**5. Net Weight [kg]:**

9.00

**6. Gross Width [mm]:**

310

**7. Gross depth [mm]:**

515

**8. Gross Height [mm]:**

440

**9. Gross Weight [kg]:**

10.00

**10. Device type:**

Electric unit

**11. Construction type of device:**

Table top

**12. Power electric [kW]:**

3.400

**13. Loading:**

230 V / 1N - 50 Hz

**14. Protection of controls:**

IPX4

**15. Exterior color of the device:**

Stainless steel

**16. Material:**

AISI 430

**17. Indicators:**

operation and warm-up

**18. Basin volume [l]:**

8

**19. Maximum device temperature [°C]:**

110

**20. Minimum device temperature [°C]:**

30

**21. Additional information:**

Baskets are not part of the delivery - can be purchased additionally

**22. Basket size [mm]:**

1x 210 x 235 or 3x 138 x 100

**23. Cross-section of conductors CU [mm<sup>2</sup>]:**

1

- Výkon (kW): 3,7-5 (230 V); 6,4-8,7 (400 V)